



Descrição

Conexões de aço carbono forjado, sem costura, ASTM A 234 Gr. WPB, dimensões conforme ANSI B 16.9; com extremidades chanfradas para solda de topo (BW). **Figuras 77-75-86:** Curvas de 45°, 90° e 180° raio longo. **Figuras 79-87:** Curvas de 90° e 180° raio curto. **Schedule (classes):** *Standard *Schedule 40 * Schedule XS * Schedule 80.

Observações: A pedido, fornecemos orçamento com extremidades flangeadas ANSI ou DIN. As extremidades também poderão ser retas.

FIG. 75



Curva 90° RL

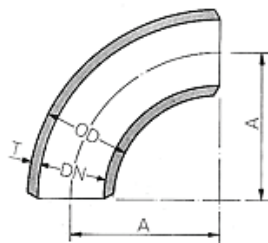

FIG. 77



Curva 45° RL

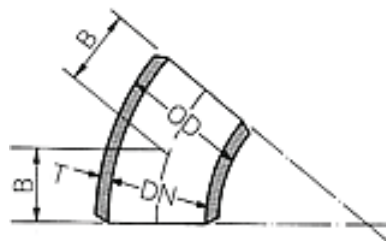

FIG. 79



Curva 90° RC

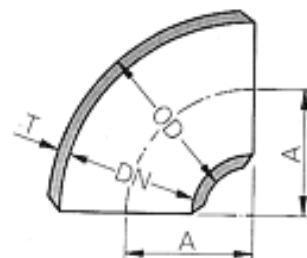

FIG. 86



Curva 180° RL

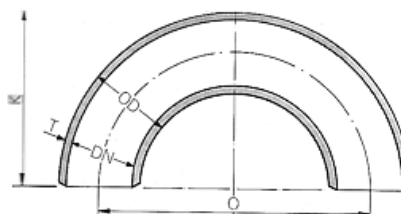
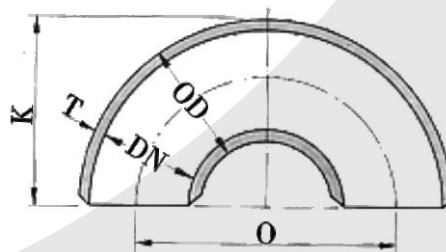

FIG. 87



Curva 180° RC



Códigos	Fig. 75			Fig. 77			Fig. 79			Fig. 86			Fig. 87		
	Sch 40	Sch 80	Sch 160	Sch 40	Sch 80	Sch 160	Sch 40	Sch 80	Sch 160	Sch 40	Sch 80	Sch 160	Sch 40	Sch 80	Sch 160
$\frac{1}{2}$	545	561	6807	436	4589	6818	—	—	—	397	7041	7057	—	—	—
$\frac{3}{4}$	546	562	6808	437	2950	6819	—	—	—	398	7042	7058	—	—	—
1	547	563	6809	582	583	6820	518	6861	6845	399	7043	7059	3174	7097	7113
1.1/4	548	564	6810	439	2949	6821	519	6862	6846	400	7044	7060	7082	7098	7114
1.1/2	549	565	576	440	2948	6822	520	6863	6847	3160	401	7061	3175	3250	7115
2	550	566	3298	441	4590	6823	521	6864	6848	402	4704	7062	7083	7099	7116
2.1/2	551	567	578	442	4591	3296	522	6865	3163	403	7045	7063	7084	7100	3162
3	552	568	579	443	4592	4801	523	4576	6849	404	4692	7064	7085	7101	7117
4	553	569	580	444	3820	6824	524	4393	6850	405	7046	7065	7086	7102	7118
5	554	4183	20434	2100	4181	6825	2915	6866	6851	7032	7047	7066	7087	7103	7119
6	555	571	577	445	4596	6826	525	6867	6852	4883	7048	7067	7088	7104	7120
8	556	570	575	446	2951	6827	526	6868	6853	7033	7049	7068	7089	7105	7121
10	4052	4051	6811	4392	6837	6828	557	6869	6854	7034	7050	7069	7090	7106	7122
12	4419	4691	6812	581	6838	6829	4094	6870	6855	7035	7051	7070	7091	7107	7123
14	4444	6802	6813	4445	6839	6830	4882	6871	6856	7036	7052	7071	7092	7108	7124
16	4594	6803	6814	4174	6840	6831	3124	6872	6857	7037	7053	7072	7093	7109	7125
18	572	6804	6815	2243	6841	6832	516	6873	6858	7038	7054	7073	7094	7110	7126
20	573	6805	6816	6835	6842	6833	517	6874	6859	7039	7055	7074	7095	7111	7127
24	574	6806	6817	6836	6843	6834	6876	6875	6860	7040	7056	7075	7096	7112	7128

CONEXÕES TUBULARES

Curvas

Aço Carbono
Forjado

Diâmetro		Espesura da Parede			Centro Face		Centro a Centro		Altura do arco		Pesos aproximados Kg								
Nom. Pol	Ext. mm	T mm		B mm	A mm	O mm		K mm		45°RL			90°RL						
DN	OD	Sched. 40	X-S	Sched. 80	45° RL	90° RL	90° RC	180° RL	180° RC	180° RL	180° RC	Std.	Sched. 40	X-S	Sched. 80	Std.	Sched. 40	X-S	Sched. 80
1/2"	21.30	2.77	3.73	3.73	15.87	38.10	-	76.20	-	47.62	-	0.04	0.04	0.05	0.05	0.08	0.08	0.09	0.09
3/4"	26.57	2.87	3.91	3.91	15.87	38.10	-	76.20	47.62	42.90	-	0.04	0.04	0.05	0.05	0.08	0.08	0.10	0.10
1"	33.40	3.38	4.55	4.55	15.90	38.10	25.40	76.20	50.80	55.60	41.30	0.08	0.08	0.10	0.10	0.15	0.15	0.20	0.20
1.1/4"	42.16	3.56	4.85	4.85	19.84	47.60	31.75	95.20	63.50	69.80	52.40	0.13	0.13	0.18	0.18	0.26	0.26	0.35	0.35
1.1/2"	48.26	3.68	5.08	5.08	23.83	57.20	38.10	114.30	76.20	82.60	61.90	0.19	0.19	0.25	0.25	0.38	0.38	0.51	0.51
2"	60.32	3.91	5.54	5.54	31.80	76.20	50.80	152.40	101.60	106.40	81.00	0.34	0.34	0.47	0.47	0.68	0.68	0.94	0.94
2.1/2"	73.02	5.16	7.01	7.01	39.76	95.20	63.50	190.50	127.00	131.80	100.00	0.68	0.68	0.90	0.90	1.35	1.35	1.79	1.79
3"	88.90	5.49	7.62	7.62	47.60	114.30	76.20	228.60	152.40	158.80	120.70	1.06	1.06	1.44	1.44	2.12	2.12	2.87	2.87
4"	114.30	6.02	8.56	8.56	63.50	152.40	101.60	304.80	203.20	209.60	158.80	2.02	2.02	2.81	2.81	4.04	4.04	5.62	5.62
5"	141.30	6.55	9.52	9.52	79.40	190.50	127.00	381.00	254.00	261.90	196.80	3.42	3.42	4.85	4.85	6.85	6.85	9.71	9.71
6"	168.30	7.11	10.97	10.97	95.30	228.60	152.40	457.20	304.80	312.70	236.50	5.30	5.30	8.03	8.03	10.70	10.70	16.00	16.00
8"	219.00	8.18	12.70	12.70	127.0	304.80	203.20	609.60	406.40	414.30	312.70	10.70	10.70	16.20	16.20	21.30	21.30	32.20	32.20
10"	273.00	9.27	12.70	15.10	158.80	381.00	254.00	762.00	508.00	517.50	390.50	18.90	18.90	25.40	30.00	37.60	37.60	50.80	60.00
12"	323.80	9.52	10.30	12.70	190.50	457.20	304.80	914.40	609.60	619.10	466.70	27.90	30.00	36.70	50.00	55.80	60.00	73.50	100.00
14"	355.60	9.52	11.10	12.70	222.20	533.40	355.60	1067.00	711.20	711.20	533.40	35.80	41.30	47.20	70.00	71.70	82.60	94.30	140.00
16"	406.40	9.52	12.70	21.40	254.00	609.60	406.40	1219.00	812.80	812.80	609.60	47.20	62.20	62.10	102.20	93.90	124.40	124.00	204.40
18"	457.20	9.52	14.30	23.80	285.80	685.80	457.20	1373.00	914.40	914.40	685.80	52.90	88.60	78.90	144.00	119.00	177.20	157.00	288.00
20"	508.00	9.52	15.10	26.30	317.50	762.00	508.00	1524.00	1016.00	1016.00	762.00	73.50	115.00	97.10	195.90	147.00	230.00	194.00	391.80
22"	558.00	9.52	-	28.60	349.30	838.20	-	1676.00	-	1118.00	-	89.00	-	118.00	-	178.00	-	236.00	-
24"	609.60	9.52	17.50	31.00	381.00	914.40	609.60	1829.00	1219.00	1219.00	914.40	106.00	192.20	141.00	336.00	212.00	384.40	282.00	668.00

Ø nominal	Pol	Tolerâncias				Espessura da parede mm	Centro a face A e B	Centro a centro O	Altura do arco K
		Ø externo mm	OD	±	mm				
Até 2.1/2"		+ 1.6 - 0.8	OD		mm	mm	mm	mm	mm
3 e 4		± 1.6			± 1,6	± 6,4	± 6,4	± 6,4	± 6,4
5 a 8		+2.4 - 1.6			± 1,6	± 6,4	± 6,4	± 6,4	± 6,4
10 a 18		+4 - 3.2			± 2,4	± 9,5	± 9,5	± 6,4	± 6,4
20 a 24		+6.4 - 4.8			± 2,4	± 9,5	± 9,5	± 6,4	± 6,4